



# Case Study

St Pancras International Station, London

**HCP**

Perimeter Heating

## HCP provides perimeter heating solution for award-winning St Pancras International station

HCP, a division of SAS International, supplied and installed approximately 300m of bespoke stainless steel perimeter heating to the new St Pancras International station.

The perimeter heating is located around the station's nine travelators, which are a key feature in the station as they transport passengers to the departure and arrivals lounges.

The travelators feature full-height glazing on both sides, which channels daylight downwards from the train shed, brightening up the once dark Undercroft area.

The floor-mounted perimeter heating from HCP runs along the internal sides of the glazing, providing heating for occupant comfort and preventing the build up of condensation on the glazing.

Bolted to the floor of this high-footfall area, the perimeter heating is located behind protective railings to prevent accidental damage from passengers and luggage. It was manufactured to match the brushed stainless steel sides of the travelators and the protective railings, and looks striking beside the dark hardwood floor.

For over 30 years HCP has specialised in convective and radiant heating solutions. This bespoke solution was manufactured and installed within the project's tight deadline, which was set to coincide with

the official opening by Her Majesty The Queen.

Suitable for both new and refurbishment projects, perimeter heating can be independently supported at low, medium or high levels to supply continuous heating along walls or walkways. It is ideally suited for combating cold down draughts and condensation, characteristics often associated with full and half height glazing.

Metal ceiling solutions and bespoke lighting rafts were also supplied by SAS International for the fit-out.

St Pancras station is now London's international terminus and a landmark transformation of the Grade I Listed original station has been achieved. The six Eurostar platforms have pride of place in the famous Barlow train shed, whilst the building's interior has been fitted out so that old meets new in a stunning combination.

London & Continental Railways' in-house team, worked with a huge construction team on this vast and varied £800m project, the main contractor being Corber (Costain, Laing O'Rourke, Bachy Soletanche and Emcor Rail).

This London terminus houses the gateway to the UK's first high-speed rail line, cutting the travel time to Paris to two and a quarter hours. St Pancras has secured its place in the 21st Century world of train travel.

**Project Name:** St Pancras International

**Client:** London & Continental Railways

**Architect:** London & Continental Railways

**Main Contractor:** CORBER Consortium

**System Type:** HCP Perimeter Heating

**Special Requirements:** Stainless steel casings

**Length:** 300 Linear Metres

**Location:** London

**Completion Year:** 2007

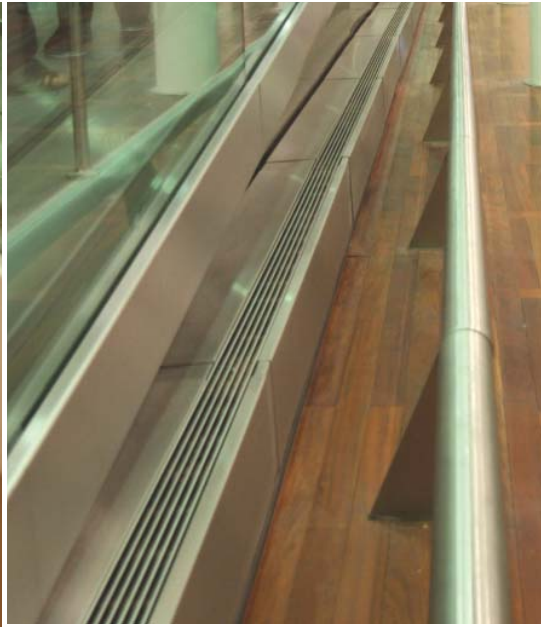

# Technical Information:

## Plan view

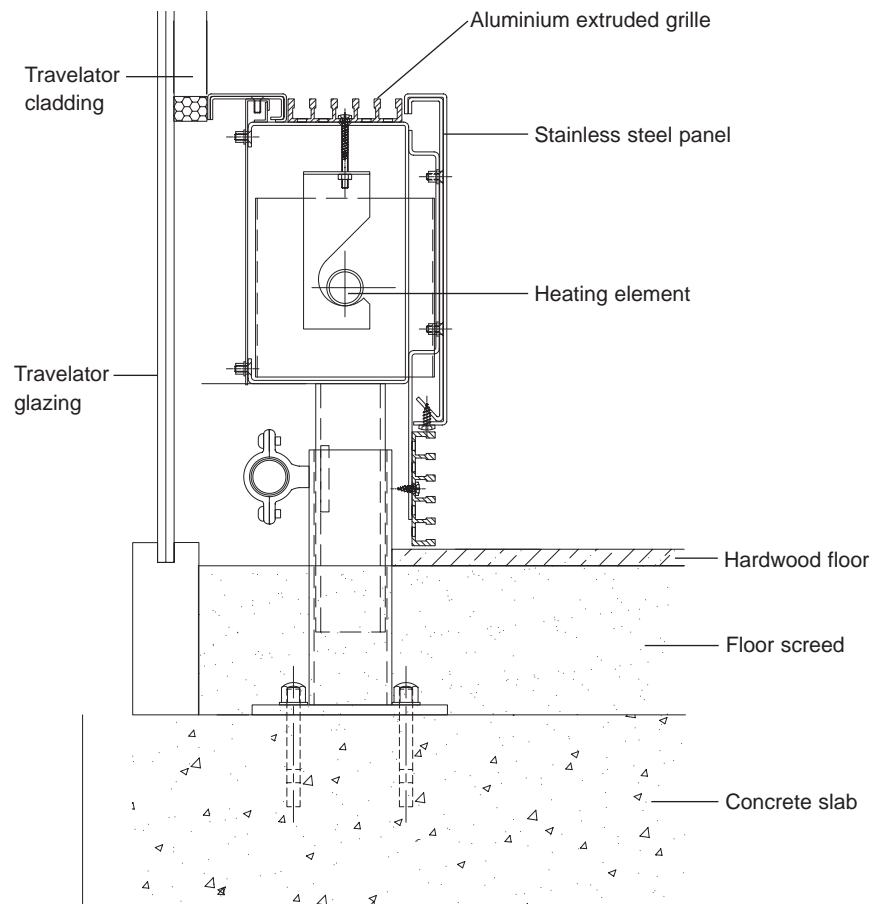

## Detail drawing

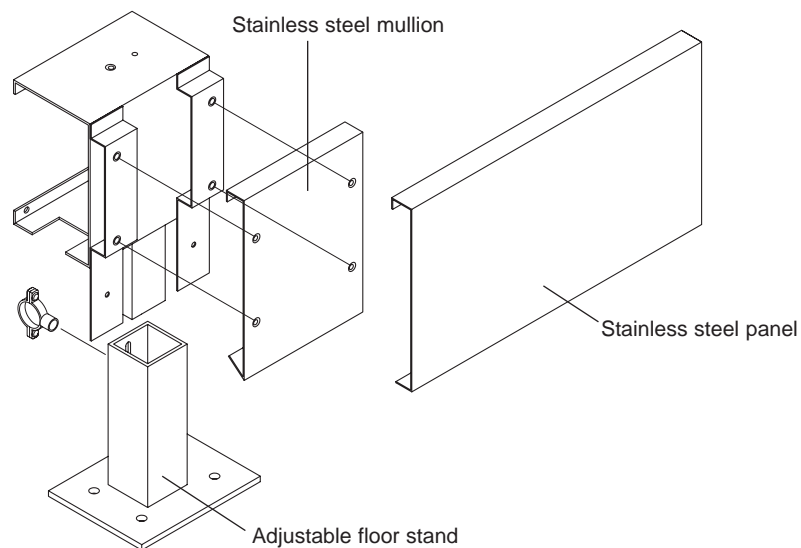

HCP (a division of SAS International)  
Chichester Road, St Leonards on Sea, East Sussex TN38 9BG  
Tel: 01424 712195 Fax: 01424 457331 info@hcp-sasint.co.uk www.hcp-sasint.co.uk

All Information and details in this leaflet are correct at time of going to press.  
Published by SAS International. All rights reserved. Copyright © 2008